



## Harrison Terrace

Darlington DL3 6QJ

£575 Per Calendar Month







This footer paragraph is an example only and should not be relied upon as complying with current legislation. These particulars, whilst believed to be accurate are set out as a general outline only for guidance and do not constitute any part of an offer or contract. Intending purchasers should not rely on them as statements of representation of fact, but must satisfy themselves by inspection or otherwise as to their accuracy. No person in this firms employment has the authority to make or give any representation or warranty in respect of the property.

# Harrison Terrace

Darlington DL3 6QJ



- Two Bedrooms
- Close To Hospital

- Yard To Rear
- Close To Local amenities

- Denes Location
- Council Tax Band A

NO DEPOSIT OPTION AVAILABLE.

This immaculately presented, two bedroom mid terrace property is located in the heart of the Denes in Darlington. It lies within easy reach of many amenities in Cockerton Village, also, Memorial Hospital, popular schooling, and is a short distance to Darlington Town Centre.

The property benefits from gas central heating, upvc double glazing, and is neutrally and tastefully decorated throughout. Viewing comes highly recommended.

## Entrance Porch

### Lounge

13'1" x 14'3" (4.00 x 4.34)

### Kitchen / Breakfast Lunch

13'1" x 7'3" (4.00 x 2.20)

### Bathroom

### First Floor

Landing.

### Bedroom 1

13'2" x 12'2" (4.01 x 3.72)

### Bedroom 2

7'3" x 13'2" (2.22 x 4.02)

With upvc double glazed window to the rear elevation, radiator and built in cupboard housing the boiler.

## Externally

### Council Tax

Band A

### Holding Deposit

All of our rental properties require a Holding Deposit equivalent to 1 week's rent. The Tenant is entitled for this Holding Deposit to be repaid within 15 calendar days of their application proceeding. However, in most cases we hope to repay this to the Tenant on the day you move in and this will be deducted from your first month's rent. This will need to be agreed with the Tenant during the application process.

You will lose your Holding Deposit if any of the following occurs:

1. You give us false or misleading information. For example, incorrect salary/income details or you fail to tell us about a CCJ.
2. You fail a Right to Rent check and are not eligible to reside in the UK.
3. You withdraw your application.
4. You fail to take steps to enter into the tenancy by taking an unreasonable amount of time to complete and submit your application form, failing to provide necessary ID and accompanying documents within a reasonable amount of time or being unable to provide a definitive move in date.\*

\*Please be aware that all of the above is also relevant to any guarantor applications that may support your tenancy.

### Reposit - Rent without a deposit

This property is available to tenants using an alternative to the traditional deposit (bond) of 5 weeks' rent.

Using Reposit, tenants are only required to pay the equivalent of 1 week's rent (or £150, whichever is greater) as an alternative to paying the traditional deposit of 5 weeks' rent. For example, if the rent is £550, the Reposit will be the minimum payment of £150. If the rent is £750, the Reposit will be equivalent to one week's rent at £173.08.

There is no need to pay a deposit or bond. This is a one-off, non-refundable payment.

Please note that just like a traditional deposit, you are still liable for any valid, end of tenancy charges. The difference with Reposit is that you keep control of your money and only pay these if they actually occur at the end of your tenancy, rather than paying at the start.

Further information is available at [www.reposit.co.uk/tenants](http://www.reposit.co.uk/tenants).

### Deposit (bond)

The deposit (bond) amount is equivalent to 5 weeks' rent.

### Venture Properties

We are Darlington's leading letting agent, letting more properties than any other agent in Darlington, and are proud to be an independent company. What does this mean for tenants? If the property is managed by Venture Properties, you will be assigned your own Property Manager who will look after you during the duration of your tenancy. The staff will be located in our Darlington office and not in a call centre out of town, which you will get with some other agents.

[www.venturepropertiesuk.com](http://www.venturepropertiesuk.com)

GROUND FLOOR 35.36 sq. m.  
( 380.59 sq. ft. )

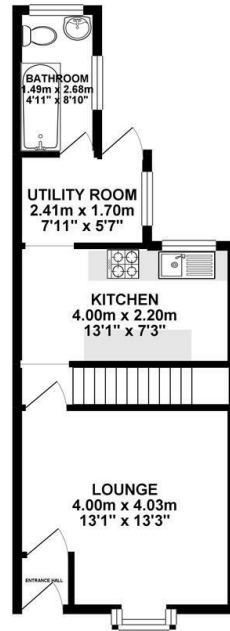

1ST FLOOR 26.98 sq. m.  
( 290.43 sq. ft. )

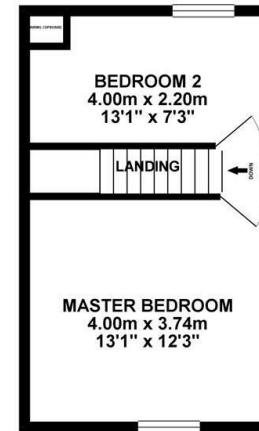

TOTAL FLOOR AREA: 62.34 sq. m. ( 671.02 sq. ft. ) approx.

Whilst every effort has been made to ensure the accuracy of the floorplan contained herein, measurements of doors, windows, rooms and any other items are approximate and no responsibility is taken for any error, omission or misstatement. This plan is for guidance purposes only and should be used as such for any prospective purchaser. The services, systems and appliances shown have not been tested and no guarantee as to their operability or efficiency can be given.  
Made with Metrepro ©2019

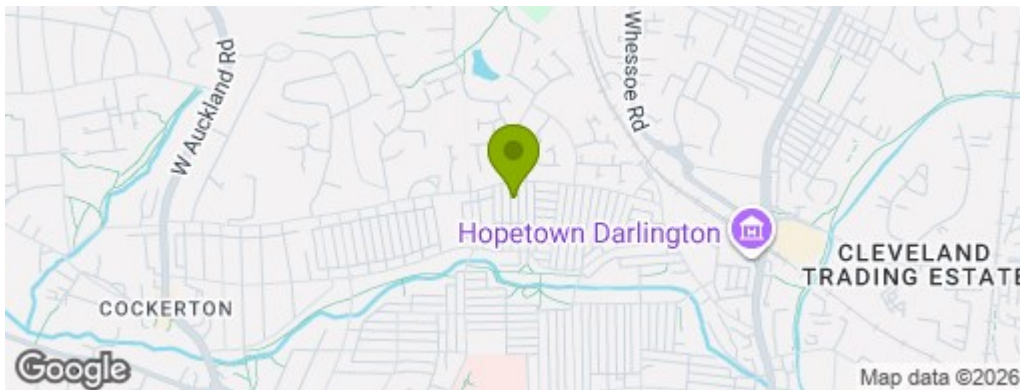

## Property Information

**01325 363858**

45 Duke Street, Darlington, County Durham, DL3 7SD  
enquiries@venturepropertiesuk.com